

IMS ENGINEERING COLLEGE	IMSEC/QF/48
FORMATS	Page 1 of 1
	Issue No: 02
Tutorials/Assignments/Quizes	Issue Date: 1 May 2010
Prepared by: MR	Approved by: Director

Subject Name	Structural Analysis-I	Subject Code : CE-401
Date of Handout	11/02/14	Max. Marks :05
Date of Submission	15/02/14	

ASSIGNMENT NO. - 1

- Q1. What is meant by statically determinate and indeterminate structures.
- Q2. Show how the static indeterminacy of a truss is determined by taking a suitable example.
- Q3. What are the various methods of analysis of truss. Explain each in detail.
- Q4. Find out the forces in the members of the truss shown below using method of joints and then cross check the forces using method of section.

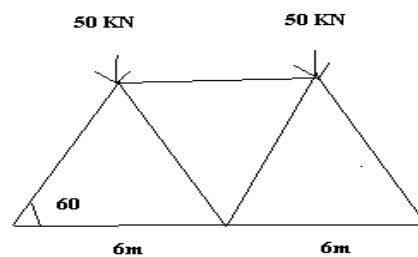

Illustration 1: